

HUDY #10 6000 ASSEMBLY TOOL FOR DRIVE SHAFTS for 3mm pin

Do NOT spend money on new drive shafts for your RC car when only pins are worn out. Now you can use the HUDY Assembly Tool and exchange the old worn-out pins for brand new pins. Using the HUDY Assembly Tool is very easy, comfortable and effective. A set of high-quality replacement pins are available from HUDY.

- This assembly tool is designed to remove and install 3mm pins.
- When removing and/or installing pins always use a suitable holding device to hold the assembly tool safely.
- Use a suitable hard-pad and hammer for removing and installing pins.
- Always use safety eyewear when using this tool.

INSTRUCTION MANUAL

PRESSING OUT THE USED PIN

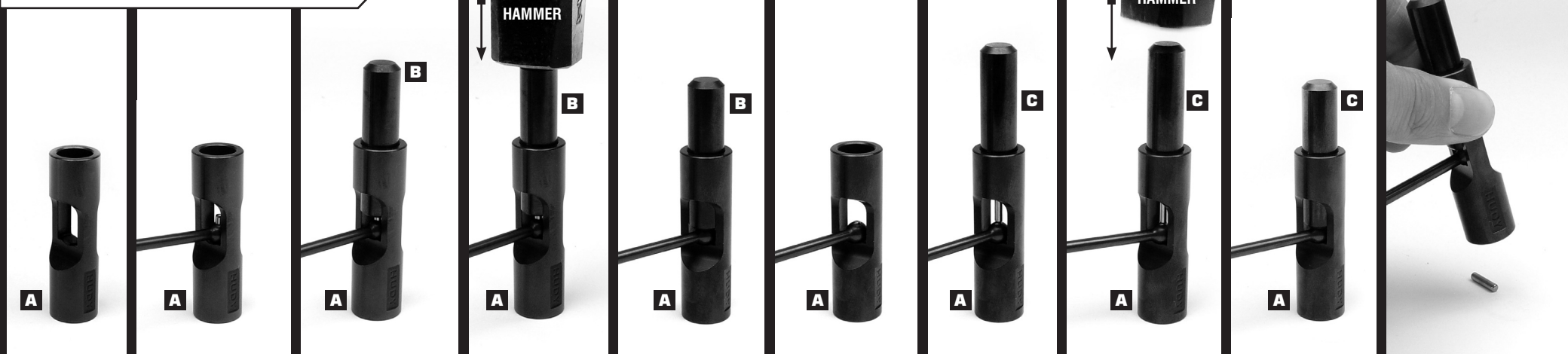

PRESSING IN A NEW PIN

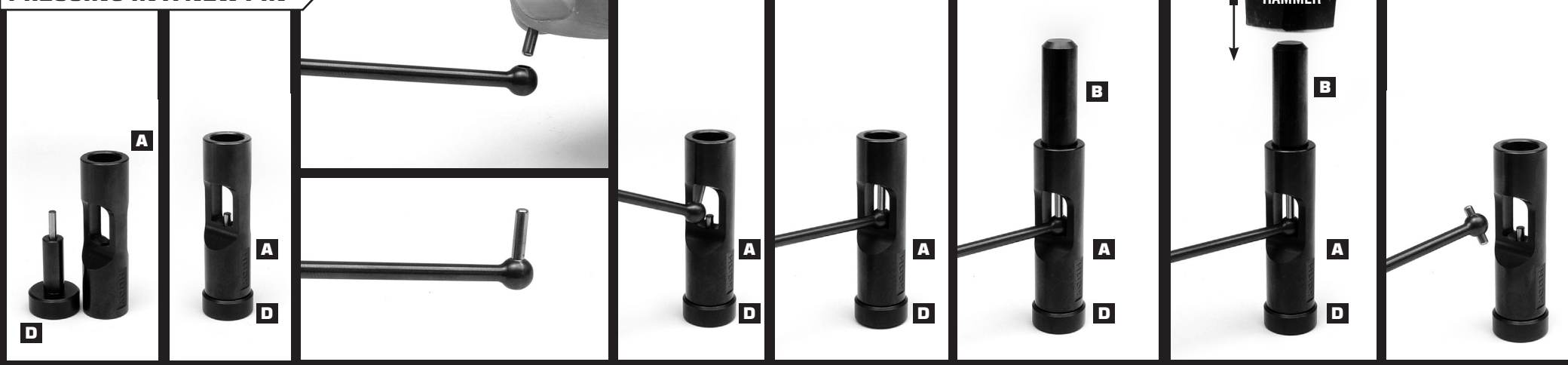

WARNING:

This is not a toy, it is a precision hand tool. This product is not intended for use by children without direct supervision of a responsible, knowledgeable adult. Contents of box may differ from pictures. In line with our policy of continuous product development, the exact specifications of the product may vary without prior notice.

Take appropriate safety precautions when using this tool; you are responsible for its safe and proper use. Please read the instruction manual before using this tool and follow all safety precautions. First time users should seek advice from people who have used this product already in order to use this product correctly and safely.

Improper use may cause personal and/or property damage. HUDY and its distributors have no control over damage resulting from shipping, improper construction, or improper usage. HUDY assumes and accepts no responsibility for personal and/or property damages resulting from the use of improper building materials, equipment and operations. By purchasing any item produced by HUDY, the buyer expressly warrants that he/she is in compliance with all applicable federal, state and local laws and regulation regarding the purchase, ownership and use of the item. The buyer expressly agrees to indemnify and hold harmless HUDY for all claims resulting directly or indirectly from the purchase, ownership or use of the product. By the act of using this product, the user accepts all resulting liability. If the buyer is not prepared to accept this liability, then he/she should return this product in new and unused condition to the place of purchase.

WARRANTY:

HUDY guarantees this tool to be free from defects in both material and workmanship within 30 days of purchase. The total monetary value under warranty will in no case exceed the cost of the original tool purchased. This warranty does not cover any components damaged by use or modification or as a result of wear. No part will be sent under warranty without proof of purchase. Should you find any defect, contact the local distributor. Service and customer support will be provided through local hobby store where you have purchased the tool or by the distributor, therefore make sure to purchase any HUDY products at your local hobby store.

HUDY has no control over usage of this tool once it leaves the dealer, therefore HUDY can only offer warranty against all manufacturer's defects in materials, workmanship, and assembly at point of sale and before use. No warranties are expressed or implied that cover damage caused by what is considered normal use, or cover or imply how the tool will last before requiring replacement. This tool is a consumable item which needs to be replaced frequently.

Any and all warranty coverage will NOT cover replacement of any part or component damaged by neglect, abuse or improper or unreasonable use. This includes but is not limited to damage from breaking or anyhow else damaging the tool, chemical and/or water damage or corrosion, improper or no maintenance, or user modifications which compromise the integrity of components.

HUDY does not pay nor refund shipping on any component sent to HUDY or its distributors for warranty. HUDY reserves the right to make the final determination of the warranty status of any component or part.

Always:

- always use protective gloves when using this product
- always wear eye-protection (glasses) when using this product
- always ensure that you are working in safe and obstacle-free area where you cannot injure others
- always when learning to use this tool, go to an area that has no obstacles that can injure others
- always make sure you are sensible when using this product
- always safely store the tool any time you are not using it
- always when you are not sure if you are able to use this tool properly and safely, do NOT use it at all

Never:

- never use this tool for any other purpose than it is designed for
- never let the tool fall on the floor, as it might break
- never let any other item to fall on the tool, as it may break the tool
- never use this tool to work on electrical items; severe injury or electrocution may result
- never put this tool inside rotating and moving parts, as this may cause damage and/or serious injury
- never try to fix the tool when you break it or wear it out

LIMITATIONS OF LIABILITY:

HUDY makes no other warranties expressed or implied.

HUDY shall not be liable for any loss, injury or damages, whether direct, indirect, special, incidental, or consequential, arising from the use, misuse, or abuse of this product and/or any product or accessory required to use this product. In no case shall HUDY's liability exceed the monetary value of this product. All rights reserved.

We hope that you will be satisfied with the performance and quality of this product. If you have any questions or advice about how to improve this product, please do not hesitate to contact us.

Thank you for choosing HUDY products!

HUDY, Pred Polom 762, 911 01 Trenčín, Slovak Republic, Europe,
tel.: ++421 32 7440 180, fax: ++421 32 7440 179,

info@hudy.net
www.hudy.net